

# Radipole road

Fulham, SW6

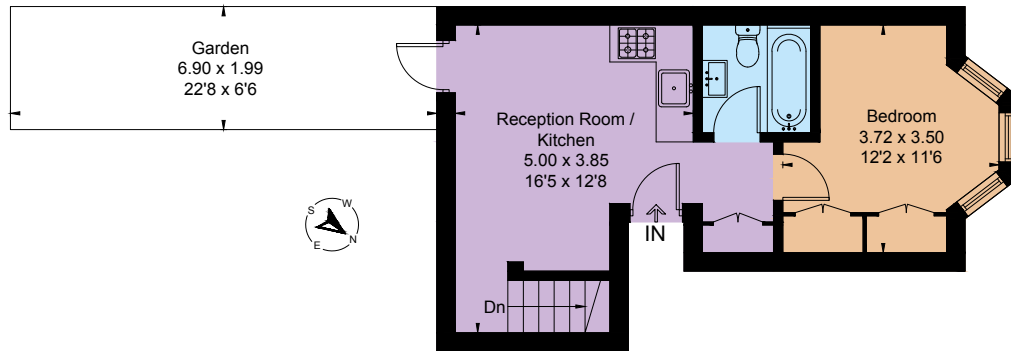



Ground Floor

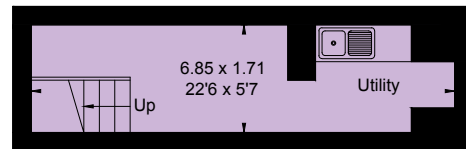

Lower Ground Floor



An exceptional one bedroom garden flat situated on a prime road within close proximity of Parsons Green.

Positioned on the ground floor of a characterful Victorian terraced house, the property effortlessly combines period charm with contemporary modern living.

The double bedroom is located at the front of the property which is naturally well lit by the bay window and features floor-to-ceiling built-in wardrobes. There is a spacious kitchen/reception room which has a voluminous feel due to the high ceilings and offers immediate access out to the Southwest facing garden. Completing the accommodation, there is a main bathroom and also a cellar that is currently set up as a utility room.

### Floorplans

Gross internal area 485 sq ft (45.1 sq m)  
For identification purposes only.

### General

- Tenure: Share of Freehold
- Local Authority: Hammersmith and Fulham
- Service Charge: TBC
- Ground Rent: TBC
- Council Tax: Band C
- EPC Rating: B
- Parking: Residents on street parking
- Broadband: Available
- Asking Price: £560,000

### Fulham

701 Fulham Road, London SW6 5UL

020 7731 7100

fulham@struttandparker.com

struttandparker.com

**IMPORTANT NOTICE:** Strutt & Parker gives notice that: 1. These particulars do not constitute an offer or contract or part thereof. 2. All descriptions, photographs and plans are for guidance only and should not be relied upon as statements or representations of fact. All measurements are approximate and not necessarily to scale. Any prospective purchaser must satisfy themselves of the correctness of the information within the particulars by inspection or otherwise. 3. Strutt & Parker does not have any authority to give any representations or warranties whatsoever in relation to this property (including but not limited to planning/building regulations), nor can it enter into any contract on behalf of the Vendor. 4. Strutt & Parker does not accept responsibility for any expenses incurred by prospective purchasers in inspecting properties which have been sold, let or withdrawn. 5. We are able to refer you to SPF Private Clients Limited ("SPF") for mortgage broking services, and to Alexander James Interiors ("AJI"), an interior design service. Should you decide to use the services of SPF, we will receive a referral fee from them of 25% of the aggregate of the fee paid to them by you for the arrangement of a mortgage and any fee received by them from the product provider. Should you decide to use the services of AJI, we will receive a referral fee of 10% of the net income received by AJI for the services they provide to you. 6. If there is anything of particular importance to you, please contact this office and Strutt & Parker will try to have the information checked for you. Photographs taken March 2025. Particulars prepared March 2025. Strutt & Parker is a trading style of BNP Paribas Real Estate Advisory & Property Management UK Limited

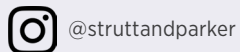

Over 50 offices across England and Scotland, including Prime Central London

For the finer things in property.

