



St. Luke's Road, Notting Hill, W11

St. Luke's Road, Notting Hill, W11

A charming two bedroom flat with a large west facing garden.

Located in the heart of Notting Hill, this spacious and well-presented flat is situated in a handsome period building. Benefitting from its own entrance, the flat has well balanced accommodation with two generously sized bedrooms and a large open plan kitchen/reception room with French doors leading out onto a lovely 36ft west facing garden.

St. Luke's Road is extremely well located close to Portobello Road, Ledbury Road and Westbourne Grove and the plentiful amenities the area has to offer.

Entrance hall | Kitchen/Reception room
Two bedrooms | Family bathroom | Study
Garden | EPC rating C

Terms

Tenure: Leasehold. 189 years from 25.12.1981

Service Charge: Approximately £2,500 per annum

Local Authority: The Royal Borough of Kensington and Chelsea

Price: £995,000 Subject to Contract

Please Note: Photographs taken in 2015.

Notting Hill

303 Westbourne Grove, London, W11 2QA

020 7221 1111

nottinghill@struttandparker.com

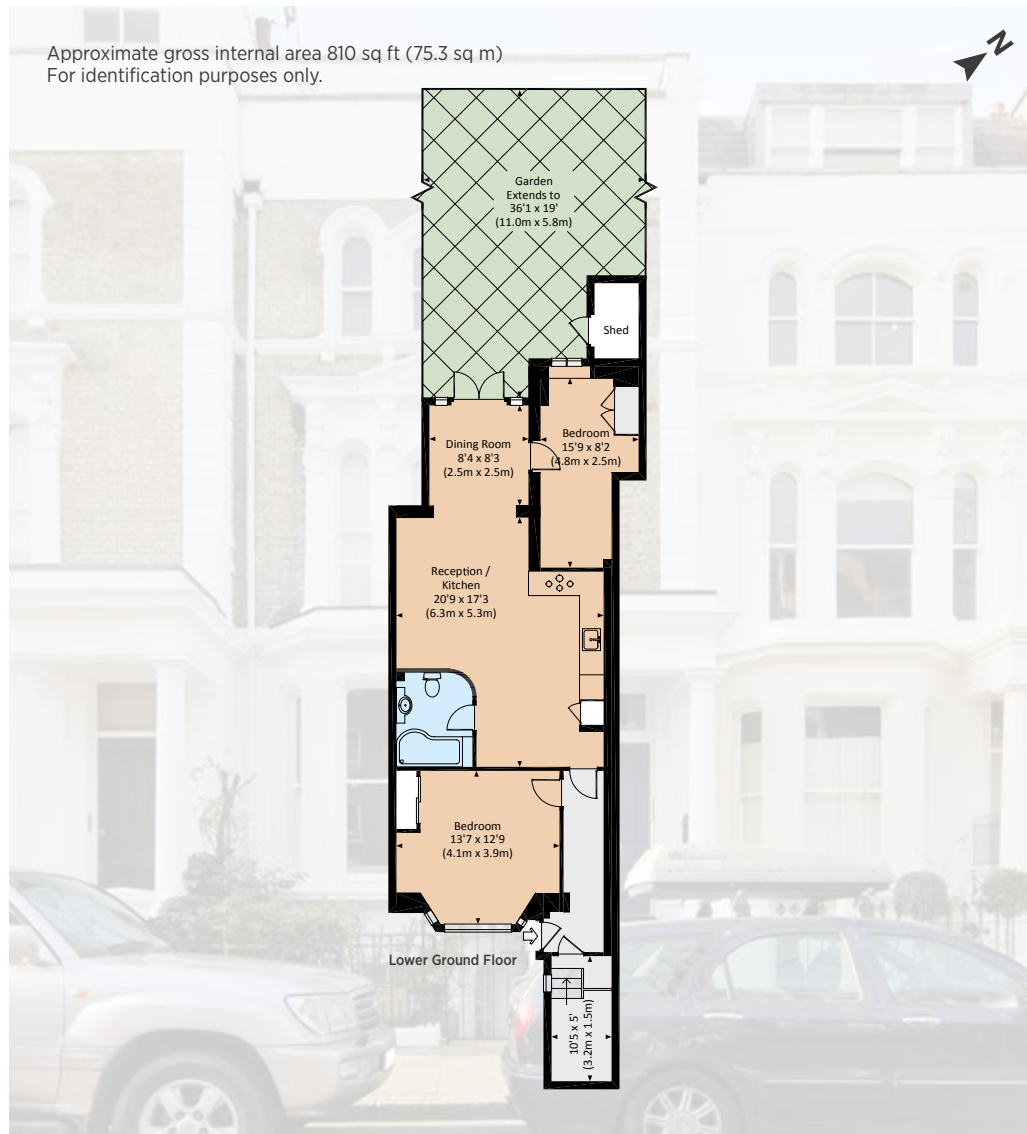

IMPORTANT NOTICE

Strutt & Parker gives notice that: 1. These particulars do not constitute an offer or contract or part thereof. 2. All descriptions, photographs and plans are for guidance only and should not be relied upon as statements or representations of fact. All measurements are approximate and not necessarily to scale. Any prospective purchaser must satisfy themselves of the correctness of the information within the particulars by inspection or otherwise. 3. Strutt & Parker does not have any authority to give any representations or warranties whatsoever in relation to this property (including but not limited to planning/building regulations), nor can it enter into any contract on behalf of the Vendor. 4. Strutt & Parker does not accept responsibility for any expenses incurred by prospective purchasers in inspecting properties which have been sold, let or withdrawn. 5. We are able to refer you to SPF Private Clients Limited ("SPF") for mortgage broking services, and to Alexander James Interiors ("AJI"), an interior design service. Should you decide to use the services of SPF, we will receive a referral fee from them of 25% of the aggregate of the fee paid to them by you for the arrangement of a mortgage and any fee received by them from the product provider. Should you decide to use the services of AJI, we will receive a referral fee of 10% of the net income received by AJI for the services they provide to you. 6. If there is anything of particular importance to you, please contact this office and Strutt & Parker will try to have the information checked for you. Photographs taken 2015. Particulars prepared June 2020 Strutt & Parker is a trading style of BNP Paribas Real Estate Advisory & Property Management UK Limited.